

READ ME ! ⚠

Thank you for purchasing a Front Runner Starlink Mini Quick Release Mount.

Before you start, take a moment to familiarize yourself with the Fitting Instructions and the included components.

Refer to Page 2 for a list of all the components, quantities and tools required.

IMPORTANT WARNING! ⚠

IT IS CRITICAL THAT ALL FRONT RUNNER PRODUCTS BE PROPERLY AND SECURELY ASSEMBLED AND ATTACHED TO YOUR VEHICLE. IMPROPER ATTACHMENT COULD RESULT IN AN AUTOMOBILE ACCIDENT, AND COULD CAUSE SERIOUS BODILY INJURY OR DEATH. YOU ARE RESPONSIBLE FOR ASSEMBLING AND SECURING ALL FRONT RUNNER PRODUCTS TO YOUR VEHICLE, CHECKING THE ATTACHMENTS PRIOR TO USE, AND PERIODICALLY INSPECTING THE PRODUCTS FOR ADJUSTMENT, WEAR AND DAMAGE. THEREFORE, YOU MUST READ AND UNDERSTAND ALL OF THE INSTRUCTIONS AND PRECAUTIONS SUPPLIED WITH YOUR FRONT RUNNER PRODUCT PRIOR TO INSTALLATION OR USE. IF YOU DO NOT UNDERSTAND ALL OF THE INSTRUCTIONS AND CAUTIONS, OR IF YOU HAVE NO MECHANICAL EXPERIENCE AND ARE NOT THOROUGHLY FAMILIAR WITH THE INSTALLATION PROCEDURES, YOU SHOULD HAVE THE PRODUCT INSTALLED BY A PROFESSIONAL INSTALLER OR OTHER QUALIFIED PERSONNEL.

NOTE: Front Runner will not be responsible for any damage caused by the failure to install the product according to these instructions.

Please call us if you have any questions about the installation of this product.

1

GET ORGANIZED

IN THE BOX

1	2 X	Starlink Mini Bracket - 1 LH & 1 RH
2	2 X	M8x16 Hex Bolt
3	2 X	M8x20 Hex Bolt
4	2 X	M8x16x1.6 Flat Washer
5	2 X	M8 Nyloc Nut
6	2 X	M8 Nut Cap
7	2 X	M8 Nylon Washer
8	2 X	M8 Eye Nut

TOOLS NEEDED



13mm

FIGURE 1.1

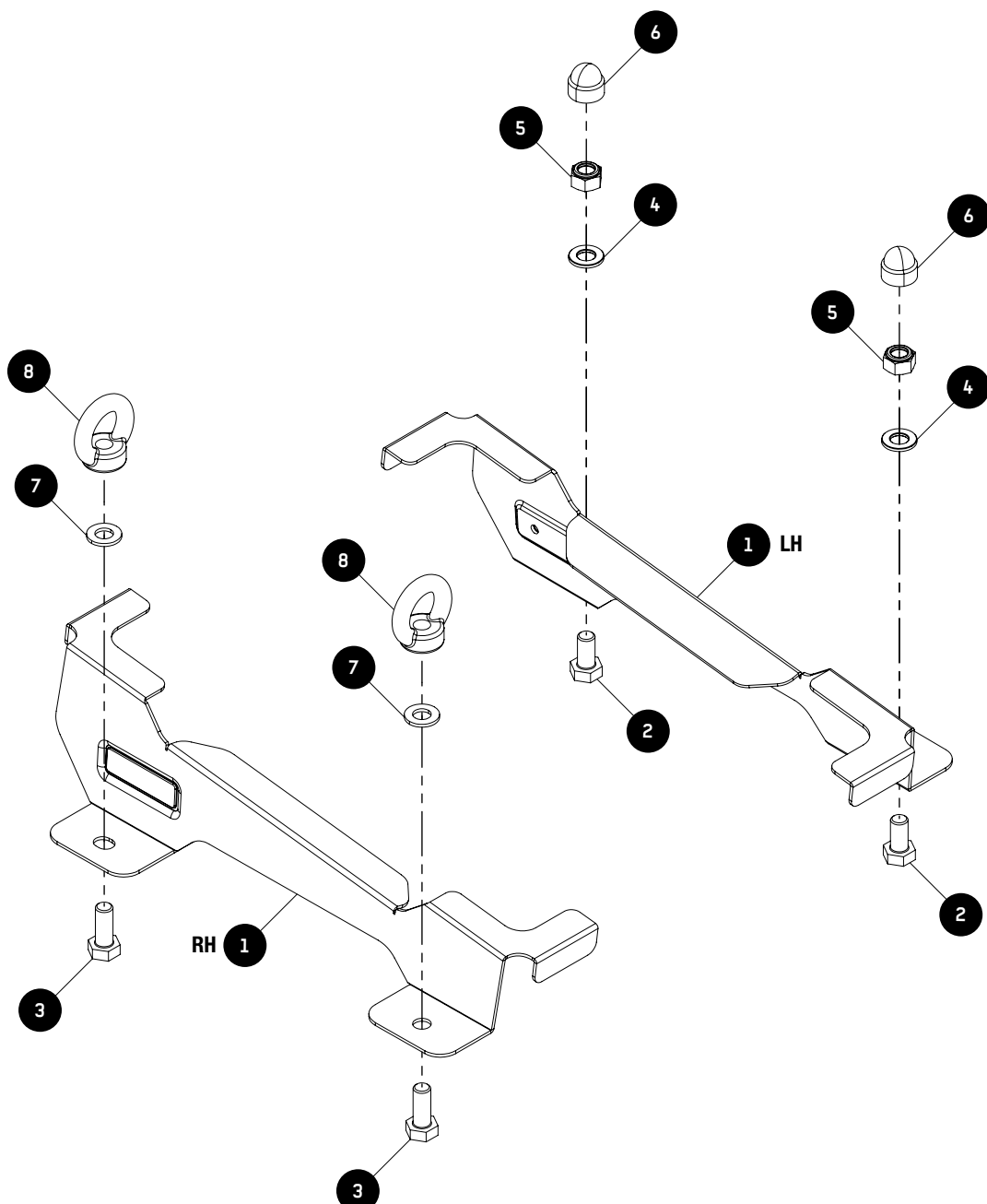

2.1

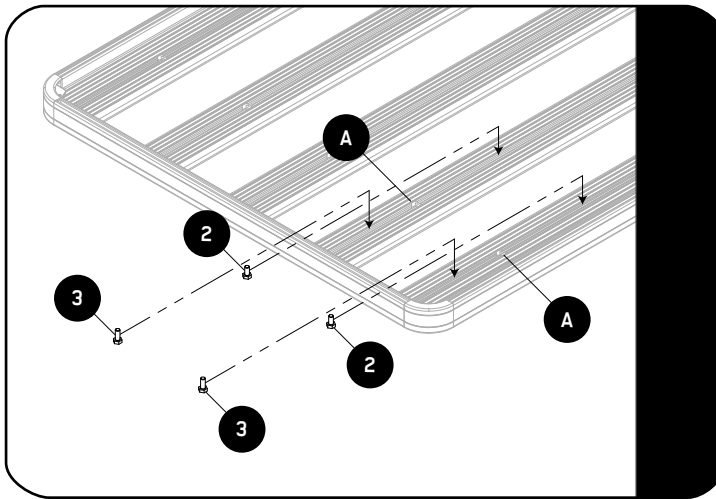

Preload the M8x16 Hex Bolts & M8x20 Hex Bolts (Item 2 & 3) into the desired slats by using the access pockets illustrated by (A), slide the bolts along the T-slot channel to the estimated positions as shown.

2.2

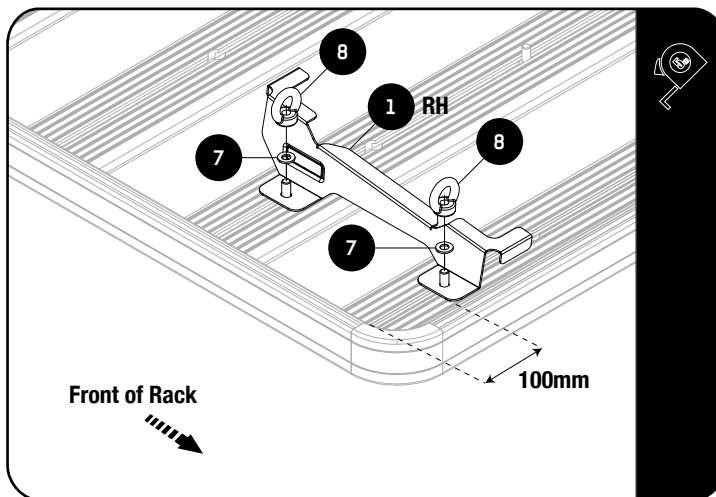

Insert the Starlink Mini Bracket (Item 1 RH) over the M8x20 Hex Bolts.

Loosely fit the M8 Nylon Washers & M8 Eye Nuts (Item 7 & 8) so that a offset measurement can be taken.

Measure 100mm from the inside edge of your rack and fully tighten the M8 Eye Nuts (Item 8).

Note: The offset distance will allow you to remove the Starlink Mini from your rack.

2.3

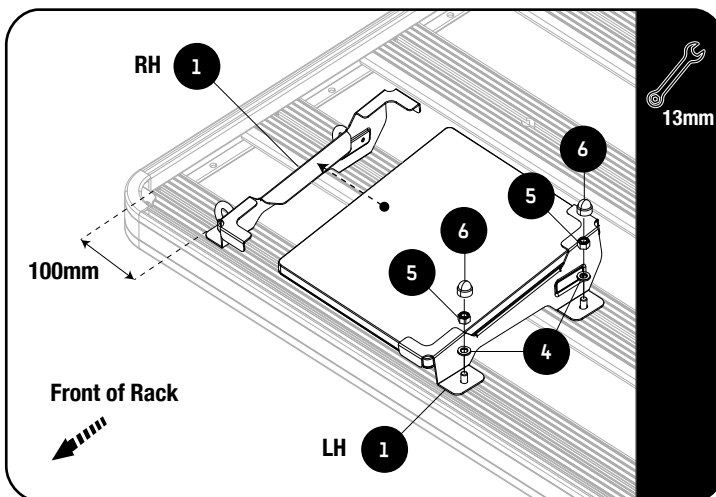

Place the Starlink Mini Bracket (Item 1 LH) over the M8x16 Hex Bolts and loosely fit the M8x16x1.6 Flat Washers and M8 Nyloc Nuts (Item 4 & 5).

With the Starlink Mini placed in the Starlink Mini Bracket (Item 1 LH), slide the assembly into the Starlink Mini Bracket (Item 1 RH) as shown.

Ensure that the Starlink Mini has a snug fit before fully tightening the M8 Nyloc Nuts (Item 5). Place the M8 Nut Caps (Item 6) over the M8 Nyloc Nuts (Item 5).



Tightening Torque:

M8 : 15-20Nm / 11.06 ft lb - 14.75 ft lb

2

FIT AND SECURE

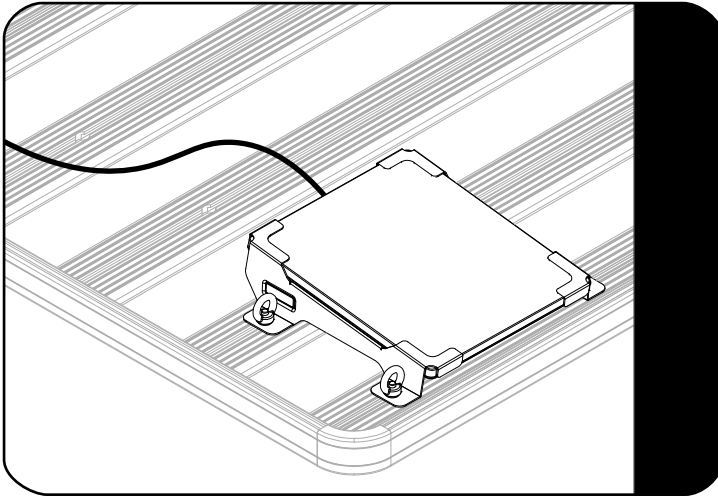
2.4

Follow the Starlink Mini installation guide to connect the Starlink.

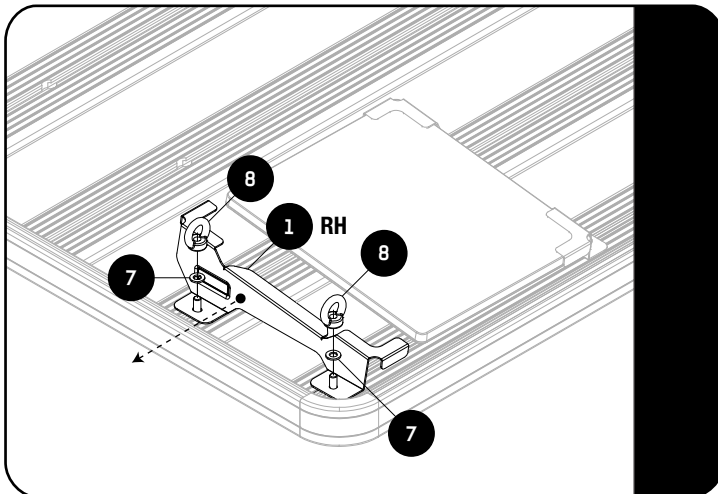
2.5

To remove the Starlink Mini from your Rack loosen the M8 Eye Nuts (Item 8) and slide the Starlink Mini Bracket (Item 1 LH) as shown.

3

FINISH

Congratulations! You did it. Take a step back and admire your work!

4

INSTALL OTHER VEHICLE AND RACK ACCESSORIES

Now's the time to visit your favorite Front Runner Dealer in person or online.

Be sure to tag us. We love to see our gear in action! #FrontRunnerOutfitters

Share your adventures on:

